



The children of today are the leaders of tomorrow. Nga mokopuna o te ra nei Nga rangatira o apopo.

WAIKANAЕ PRIMARY SCHOOL
Nature walkway

Stanjoy Charitable trust

Application for funding to:

Enhance the outdoor space at Waikanae School, making it a beautiful, relaxing space for the public and pupils.



Plan 1 - Beautification of school front																		
Current situation	Action and costings	Outcomes																
<p>Currently, the front of our school property is notorious for flooding as it lacks adequate drainage. The main gateway into our school is a highway for water flow which at times can make it difficult to use. Many students and members of our community use this entrance everyday to access the school grounds. Additionally, due to the lack of adequate drainage the large area of ground is now exposed dirt and is uninhabitable for vegetation. There are also a number of tree stumps which currently impede our future plans. At this stage the area looks and feels uninviting, and is not being used to its potential i.e. it could be a community area (outdoor classroom, picnic area for families).</p>	<p>We intend to redirect water flow to make the space usable. Improving the drainage will result in less flooding, improving the accessibility for our students and community. We would like to resurface some of the area due to it being damaged by this poor drainage. This is the main entrance to our school and the asphalt is unappealing and hazardous. Resurfacing will allow us to improve the entire area.</p> <p>In this area we would like to provide a number of seating areas surrounded by existing native trees, boxed flower beds, and interactive areas such as a sensory garden so that students and the wider community are drawn to this area. It would be a great space for families to spend time with their children before and after school. Teachers can also use this area as an outdoor classroom, which we currently do not have on our school grounds. We would also like to build pathways which will naturally lead users through this space rather than around to the side entrance of our school.</p> <p>Costings</p> <table><tr><td>Paths</td><td>\$10,000</td></tr><tr><td>Drainage</td><td>\$15,000</td></tr><tr><td>Management</td><td>\$4,000</td></tr><tr><td>Resurfacing</td><td>\$15,000</td></tr><tr><td>Furniture</td><td>\$15,000</td></tr><tr><td>Planting</td><td>\$10,000</td></tr><tr><td>Gateway</td><td>\$4,000</td></tr><tr><td>Total</td><td>\$73,000</td></tr></table>	Paths	\$10,000	Drainage	\$15,000	Management	\$4,000	Resurfacing	\$15,000	Furniture	\$15,000	Planting	\$10,000	Gateway	\$4,000	Total	\$73,000	<ul style="list-style-type: none">→ Improved drainage and resurfaced grounds→ Improved appearance of our main entrance→ Interactive sensory garden→ Oak Tree protected due to reconfigured entrance and drainage→ Established pathway for our nature walk→ Established garden→ A range of seating
Paths	\$10,000																	
Drainage	\$15,000																	
Management	\$4,000																	
Resurfacing	\$15,000																	
Furniture	\$15,000																	
Planting	\$10,000																	
Gateway	\$4,000																	
Total	\$73,000																	



Plan 1 - Front of school			
Proposed plan perspective - Garden area 900m2			









Outdoor
community
space

Nature walk
through front of
school

Pathway through
Welcoming
garden.



Plan 2 - Eco centre and garden







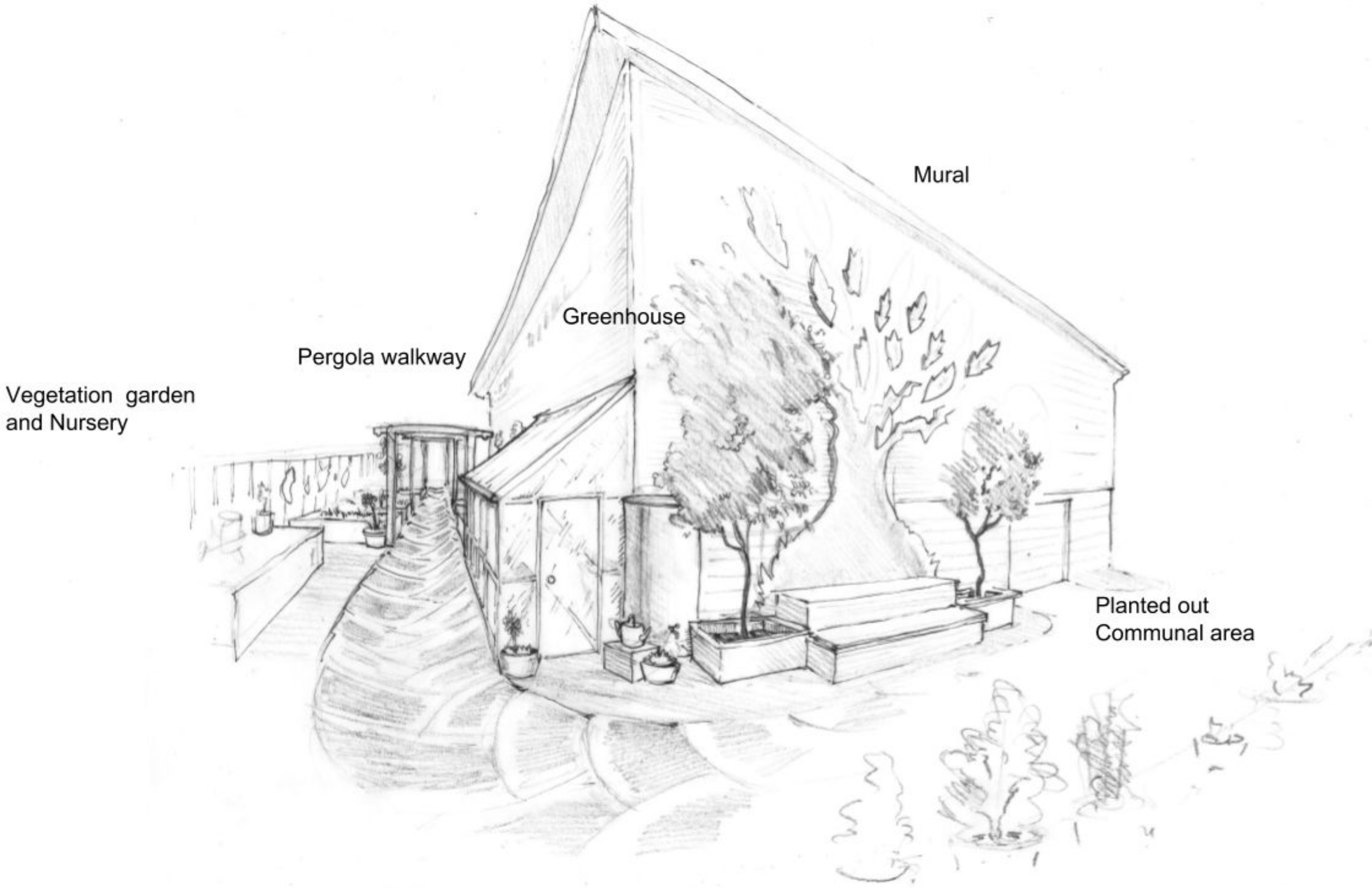



Current situation	Action and costings	Outcomes																
<p>This area is an overgrown and disused area that has great potential to be another community space that will give people access to our Enviro Centre. Adjacent to this area we have a small number of garden beds which have enabled us to involve our school and wider community in education around sustainability. Currently this area is fenced off and access is very limited. Two new classrooms were built in 2018 and the area described is the space behind these two classrooms which will facilitate the expansion of our Enviro Centre.</p>	<p>In this area we intend to establish a nursery so that students can learn more about horticulture and develop their ecological literacy. We will need to level the ground so that we can place a glasshouse, shadehouse, raised garden beds, compost bays, water tanks and worm farms so that our gardens can be self sufficient.</p> <p>We will remove the fencing that restricts access to this area, and continue the pathway from the school entrance through here. The pathway will be covered with a pergola, making the area inviting to those walking through our school grounds. To encourage users to take a moment and enjoy their surroundings, a number of seats will be placed near the garden beds and a mural created by community members and our students will decorate the surrounding classroom wall.</p> <p>Costings</p> <table><tr><td>Paths</td><td>\$3,000</td></tr><tr><td>Beds</td><td>\$8,000</td></tr><tr><td>Nursery - greenhouse/shed</td><td>\$10,000</td></tr><tr><td>Shade house</td><td>\$3,000</td></tr><tr><td>Fencing</td><td>\$4,000</td></tr><tr><td>Entrance</td><td>\$4,000</td></tr><tr><td>Compost and topsoil</td><td>\$2,000</td></tr><tr><td>Total</td><td>\$34,000</td></tr></table>	Paths	\$3,000	Beds	\$8,000	Nursery - greenhouse/shed	\$10,000	Shade house	\$3,000	Fencing	\$4,000	Entrance	\$4,000	Compost and topsoil	\$2,000	Total	\$34,000	<div><div><div><div><div>→ Greenhouse</div><div>→ Shadehouse</div><div>→ Additional garden beds</div><div>→ Worm farms</div><div>→ Compost bays</div><div>→ Seating area</div><div>→ Mural</div><div>→ Continued pathway</div><div>→ Water tanks</div><div>→ pergola</div></div><div></div></div></div></div>
Paths	\$3,000																	
Beds	\$8,000																	
Nursery - greenhouse/shed	\$10,000																	
Shade house	\$3,000																	
Fencing	\$4,000																	
Entrance	\$4,000																	
Compost and topsoil	\$2,000																	
Total	\$34,000																	

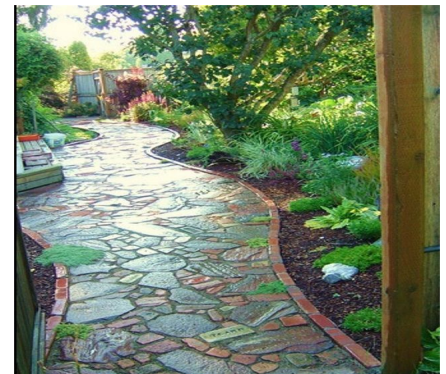

Plan 2 - Eco Centre and Garden			
Proposed plan perspective - garden area 220m2			



Plan 3 and 4 - Orchard

Current situation	Action and costings	Outcome								
<p>This is a newly configured space which exists due to the construction of four new classrooms. It is currently an empty and unused space, which our students tend to avoid. Our storage containers are located in this area and contribute to its unappealing vibe.</p> <div></div>	<p>We intend to continue the pathway through this space, which will then lead to our hall and the back entrance into our school. We will plant fruit trees to provide shade, produce and the opportunity to learn about growing your own food. To beautify the containers they will have some murals painted onto them, and other interactive fixtures such as pot plants and vines. This space will be transformed into a space which will feel warm and inviting.</p> <div><p>Costings</p><table><tr><td>Planting</td><td>\$4,000</td></tr><tr><td>Murals</td><td>\$8,,000</td></tr><tr><td>Paths</td><td>\$2,000</td></tr><tr><td>Total</td><td>\$14,000</td></tr></table></div>	Planting	\$4,000	Murals	\$8,,000	Paths	\$2,000	Total	\$14,000	<div><p>→ Vibrantly decorated containers</p><p>→ Orchard</p><p>→ Students use and enjoy this area</p><p>→ Pathway continues from the Enviro Centre and leads to the hall and back entrance into our school</p><div></div></div>
Planting	\$4,000									
Murals	\$8,,000									
Paths	\$2,000									
Total	\$14,000									



Plan 3 and 4 - Orchard			
Proposed plan perspective - Orchard area 200m2			

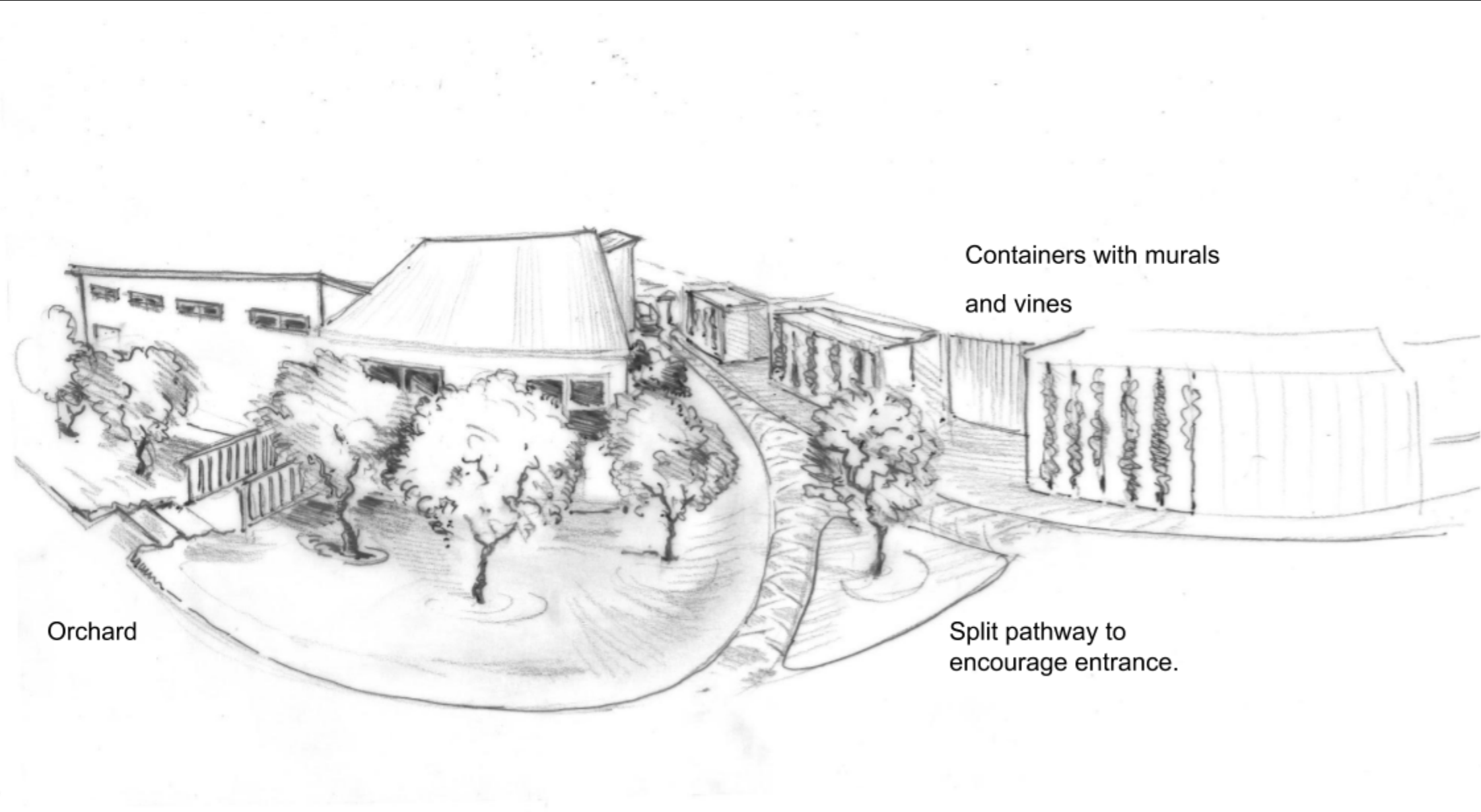

Summary

As one of only two schools in Waikanae, our school grounds are a popular destination for families during the evenings and weekends. Our fields and courts are often busy with families playing, scootering, exercising and walking through to access the connecting streets, but with the revamping of our grounds - more gardens, seating and interactive sensory spaces - our grounds will appeal to a wider range of people within our community. For example, our local preschools could bring their children through to experience our sensory garden and the main entrance could host community picnic events. This proposal also provides our children with many great learning opportunities around sustainability, growing your own food and being present in nature. These new spaces will provide enjoyment to our school and wider community for many years to come.

This Project has a total expenditure of \$121,000, Waikanae School community will gift \$21,000 in cash or in kind.



Some of our current Enviro Group members



Site Map

